

# Intrinsically Safe Field Display

for use with Easidew I.S. and Easidew PRO I.S.



## Technical Specifications

Input	
<b>Current</b>	4 to 20mA
<b>Voltage drop</b>	Less than 1.2V at 20°C (68°F) Less than 1.3V at -40°C (-40°F) Less than 5V with optional loop powered backlight
Display	
<b>Type</b>	Liquid crystal, non-multiplexed 4 digits 34mm high
<b>Resolution</b>	Dewpoint: 0.1 °C/°F ppm <sub>v</sub> /ppm <sub>w</sub> : 1 for 1000 – 9999 0.1 for 100.0 – 999.9 0.01 for 10.00 – 99.99 0.001 for 0.000 – 9.999
<b>Span</b>	Adjustable between 0 & ±9999 with a 20mA input
<b>Zero</b>	Adjustable between 0 & ±9999 with 4mA input
<b>Over-range/Under-range</b>	9999 or -9999 with all decimal points flashing
Certification (Display Only)	
<b>ATEX</b>	Group II Category 1GD Ex ia IIC T5 Ga Ta = -40 to +70°C
<b>IECEX</b>	Ex ia IIC T5 Ga Tamb = -40 to 70°C
<b>FM</b>	CL I, II, III: Div 1: GP A, B, C, D, E, F & G T4 @ 70°C (158°F)
Environmental	
<b>Operating temperature</b>	-40 to +70°C (-20 to +60°C for FM version) (-40 to +158°F (-4 to 140°F for FM version))
<b>Storage temp</b>	-40 to +85°C (-40 to +185°F)
<b>Humidity</b>	to 95% at 40°C (104°F) non-condensing
<b>Enclosure</b>	IP66
Mechanical	
<b>Terminals</b>	Screw clamp for 0.5 to 1.5mm <sup>2</sup> conductors
<b>Weight</b>	1.7kg (3.75 lbs)
Accessories	
<b>Backlight</b>	Green, loop powered. Voltage drop of indicator plus backlight less than 5V
<b>Alarms</b>	Two alarm outputs each of which may be independently configured. Isolated solid state switch complying with requirements for simple apparatus. R <sub>on</sub> 5Ω + 0.7V max R <sub>off</sub> 1MΩ min
<b>External keypad</b>	Membrane keypad enables indicator to be configured without removing cover.
<b>Stainless steel legend plate</b>	Etched legend plate with tag number or application attached to front of the instrument
<b>Pipe mount kit</b>	Stainless steel bracket secured by two stainless steel worm drive hose clips for 60 to 80mm outside diameter vertical or horizontal pipe

The Intrinsically Safe Field Display is a 4-digit loop-powered local monitor for the Easidew PRO I.S. and Easidew I.S. transmitters. It is certified with ATEX, IECEX, UKCA, and FM and housed in an IP66 enclosure with a terminal compartment for wiring. The measurement unit can be labelled as ppm<sub>v</sub>, ppm<sub>w</sub>, °C dp or °F dp.

## Highlights

- Loop powered 4-20mA indicator. Intrinsically safe certified with ATEX, IECEX, UKCA, and FM
- Operating temperature between -40 and +70°C (-40 and +158°F)
- Bold 34mm high 4 digit display with optional backlight
- Robust GRP enclosure providing IP66 protection. Can be mounted by itself or inside a sampling system enclosure
- Built-in terminal compartment for easy wiring
- Two optional galvanically isolated solid state alarm outputs

## Dimensions

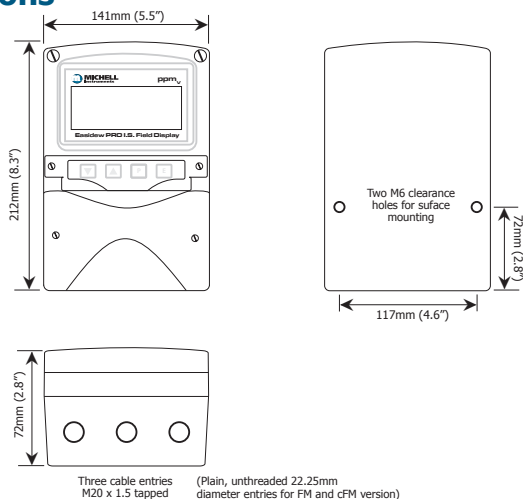

# Intrinsically Safe Field Display

## Electrical Connections

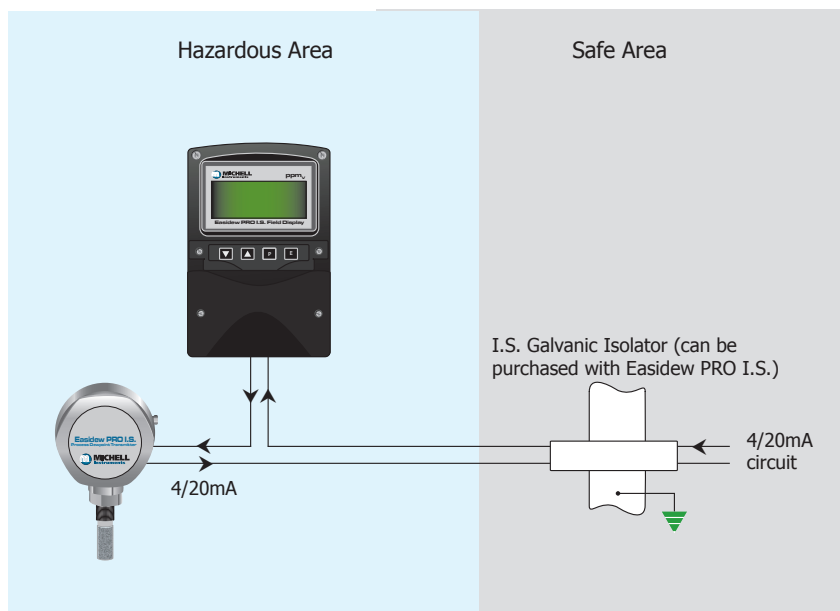

## Accessories

Pipe mount kit	<b>EPD-PMK</b>
Connection kit (including 2 cable glands and 0.5 meter cable BS5308, crimped)	<b>EPD-CAB</b>

## Ordering Codes

To construct the order code, select the relevant feature from the tables below, starting with the base model, which is {Feature A} and then add on option to create a string: {Feature A}+{Feature B}+{Feature C}+{Feature D}+{Feature E}+{Feature F}+{Feature G}

**Order example:** EPD + BX(0/100P) + C1 + D2 + E1 + F1 + G1  
 Easidew PRO I.S. Field Display, 0 to 100 ppm<sub>v</sub>, no backlight, tag plate, no alarms and no keypad, ATEX+IECEx certification.

	EPD	BX(0/100P)	C1	D2	E1	F1	G1
<b>Base Model {Feature A}</b>							
I.S. Field Display	EPD						
<b>Range {Feature B}</b>							
-100 to +20°C (-148 to +68°F) dew-point input range		B1					
v = zero value (must be the same as the associated transmitter)		BX					
w = full scale value (must be the same as the associated transmitter)							
x = unit – must be the same as the associated transmitter – (C = °Cdp, F=°Fdp, P=ppm <sub>v</sub> )							
<b>Backlight {Feature C}</b>							
No backlight			C1				
Backlight (no additional wiring required)			C2				
<b>Certification {Feature G}</b>							
ATEX Gas, IECEx							G1
ATEX Gas and dust, IECEx							G2
ATEX Gas, IECEx, FM, cFM (cable entries change from M20 to plain, unthreaded 22.25mm diameter entries)							G3
<b>Keypad {Feature F}</b>							
No keypad						F1	
External keypad						F2	
<b>Alarms {Feature E}</b>							
No alarms					E1		
Alarm switch (dual, galvanically isolated solid state)					E2		
<b>Tag Plate {Feature D}</b>							
No tag plate							D1
Stainless steel tag plate (maximum 12 characters)							D2