

## Warranty

Unless otherwise agreed, Michell Instruments warrants that, as from the date of delivery, for a period of 12 months, the goods and all their component parts, where applicable, are free from any defects in design, workmanship, construction or materials.

### **Michell Instruments Humidity and Dew-Point Instruments**

48 Lancaster Way Business Park  
Ely, Cambridgeshire CB6 3NW  
Tel: +44 (0) 1353 658000  
Fax: +44 (0) 1353 658199  
E-mail: [uk.info@michell.com](mailto:uk.info@michell.com)

**Web: [www.michell.com](http://www.michell.com)**

# Pura Dew-Point Transmitter

## Service Exchange

This Transmitter is a reconditioned/recalibrated Service Exchange Pura Transmitter.

**Contractual agreement requires that, once this sensor has been installed, the extracted sensor must be returned to us, within a two week period, as detailed in this information sheet.**

Once this extracted Pura Transmitter is inspected at our service facility in Ely, UK, and the parts found to be suitable for re-stocking, the contract will be complete.

**This is a replacement instruction sheet only - please also refer to the Pura Transmitter Manual for full instructions and additional information.**

On delivery, make sure that the transmitter is removed from the packaging materials as shown on the picture, starting from where the arrow is indicated.

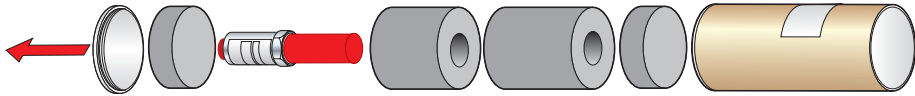

Remove the old Pura Transmitter, by unscrewing the hexagonal nut (A/F=27mm) on the 1/2" VCR-male process connection, and lifting it out carefully without damaging the sensor tile.

**NOTE: Remove and discard the 1/2" non-retained VCR seal from the sensor block.**

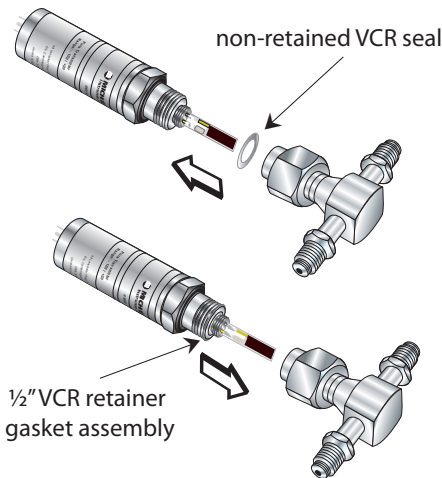

**NOTE: The new Pura Transmitter will be supplied with a 1/2" VCR retainer gasket assembly which is attached to the top of the process connection thread. Make sure that this is securely positioned and snapped in.**

**Installation Instructions**

- Install the sealing gasket onto the VCR connections on either the Pura or the connecting gas lines. Ensure that the Pura is offered into the gas line with reference to the gas flow direction and the inlet port, as indicated on the Pura body.
- Tighten the female nut firmly finger tight.
- Hold the Pura transmitter stationary with a spanner/wrench and tighten the gas line nut 1/8 (one eighth) of a turn using a second spanner/wrench.
- Repeat this operation on the remaining gas connection port.

The old Pura Transmitter must be fitted with the filter guard, and the red cap, from the Service Exchange Transmitter.

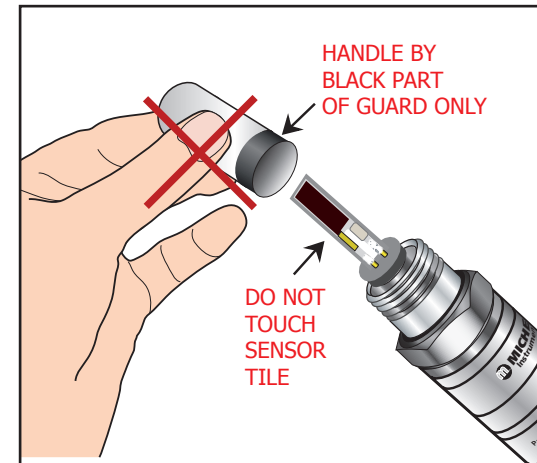

The old Pura Transmitter must be packaged into the box which the Service Exchange Transmitter was sent in.

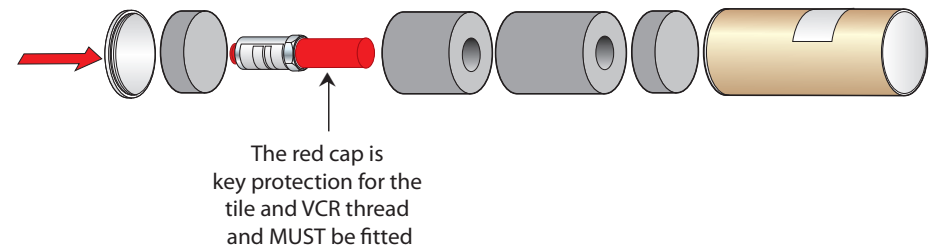

If the sensor is returned without the red cap fitted and/or damage is found on the threads, the contract will be void.

Return the package, within two weeks, to Michell Instruments via your local Michell contact point.