

### Static pressure reference probe for indoor use

## VM-2

Mi-162gb / 2005-03-22

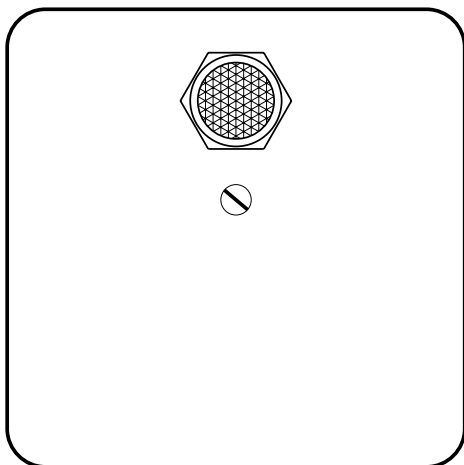

Enclosure for wall mounting

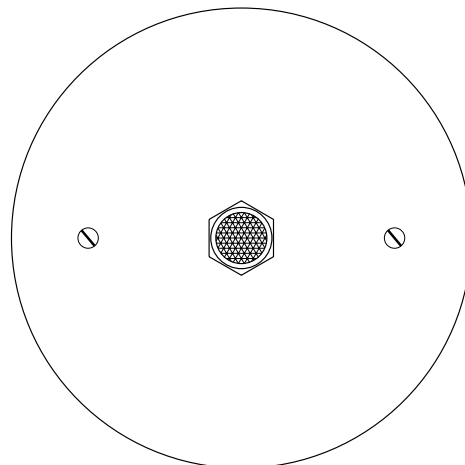

Plastic cover for recessed mounting

#### Application:

The measuring probe is designed to pick up static pressure in rooms, clean rooms, laboratories etc. The installation kit consists of a measuring probe, which shall be mounted either on the wall using the enclosure or for recessed mounting using a plastic cover.

The cover plate is also available in 304 stainless steel.

Installation with the enclosure, a straight or angled fitting shall be mounted inside the enclosure. The straight fitting for bottom entry and the angled fitting when the tubing shall be placed on the wall surface.

Installation with the plastic cover, the straight fitting shall be used for recessed wall entry, and the angled fitting when the tubing shall be placed in a conduit for optional direction.

All parts in the kit are delivered unassembled.

#### Part list:

1 pc.	Enclosure 60x60x30 mm
1 pc.	Cover Ø 90 mm (cc = 60 mm)
1 pc.	Measuring probe
1 pc.	Straight fitting 8/6
1 pc.	Angled fitting 8/6 (swivel type)
2 pcs.	Screws
1 pc.	Spacer

### Mounting with enclosure:

1. Decide a suitable way for mounting the tubing.

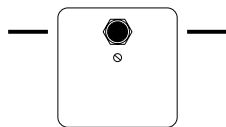

*Horizontal mounting*



*Vertical mounting*

For wall surface mounting, cut off the enclosures knockouts for suitable direction. **Note**, only the knockouts in line with the probe shall be used.

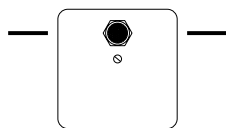

*Knock-outs to be used in line with probe*

2. Mount the enclosure with the two attached screws.
3. Mount the measuring probe and the angled fitting.

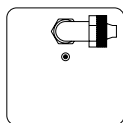

4. Attach the tubing and mount the cover.
5. Installation for bottom entry, the angled fitting is replaced by the straight fitting.

### Mounting with plastic cover:

1. Mount the measuring probe and the straight fitting for wall entry.

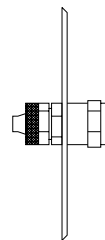

*Straight fitting*

2. Mount the angled fitting, when placing the tubing in conduit.

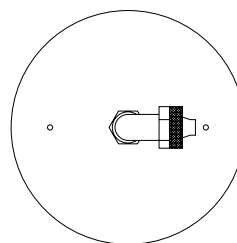

*Angled fitting*

3. Attach the tubing.
4. Mount the plastic cover with the attached screws.